

Istruzioni di Montaggio

Assembly instruction

Instructions de montage

Montageanleitung

Instrucciones de montaje

Instruções de montagem

BEVERLY

PORTA PER NICCHIA 1 ANTA SCORREVOLE

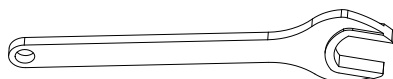

n°15

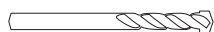
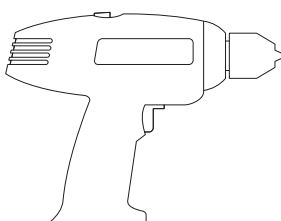
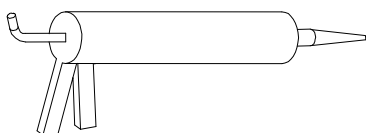

Ø 6

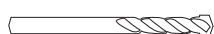

Ø 3
Ø 2,5

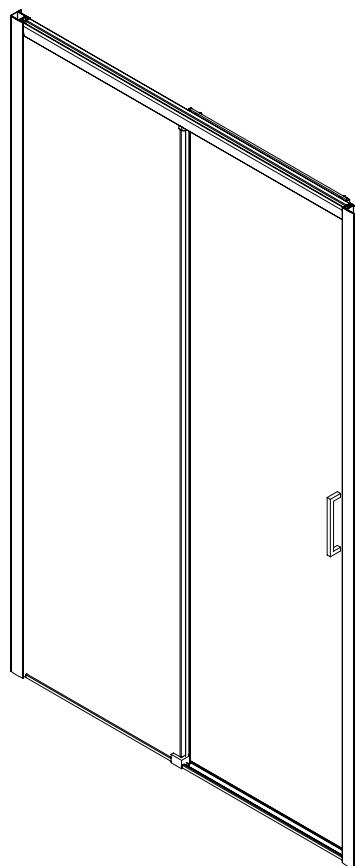

ATTENZIONE! QUESTA ISTRUZIONE MOSTRA IL MONTAGGIO DELLA PORTA DOCCIA IN VERSIONE SINISTRA, NEL CASO SI SIA OPTATO PER UNA VERSIONE DESTRA LE OPERAZIONI SONO DA ESEGUIRE UGUALI E CONTRARIE

ATTENTION! THE INSTRUCTIONS SHOW THE INSTALLATION OF A LEFT HAND VERSION OF THE SHOWER, IF YOU HAVE A RIGHT HAND VERSION THE PROCEDURES WILL BE EXECUTED THE SAME WAY, BUT ON THE OTHER HAND.

